



LOA:	41' - 10"
BEAM:	14' - 10"
DRAFT:	3' - 4"
WEIGHT:	24,700 LBS
ENGINE:	OPTIONS
FUEL:	600 GALS
DEADRISE:	20 DEGS

## North Rip

The North Rip 42 is the express sportfisherman that leverages the many benefits of light-weight building methods and materials while harnessing the power and efficiency of the next step in marine power. The pod drive system. The Pod drives offer superior maneuverability and all aspects of performance and handling while adding measurable increases in overall layout and space.

The Pod Drive system allows a layout that gives you the space to add a twin bunk stateroom with 5-9" headroom beneath the bridgedeck. With the optional guest cabin layout, the 42 sleeps six comfortably.

Pearson Marine Group utilizes the SCRIMP resin infusion process that produces a lighter, stiffer and more efficient FRP product. With Core-cell PVC sandwich construction throughout, the NR42 is a highly engineered laminate that has evolved with the research and design entity at PMG for the last fifty years of composite engineering and manufacturing.

Contact North Rip for more details.

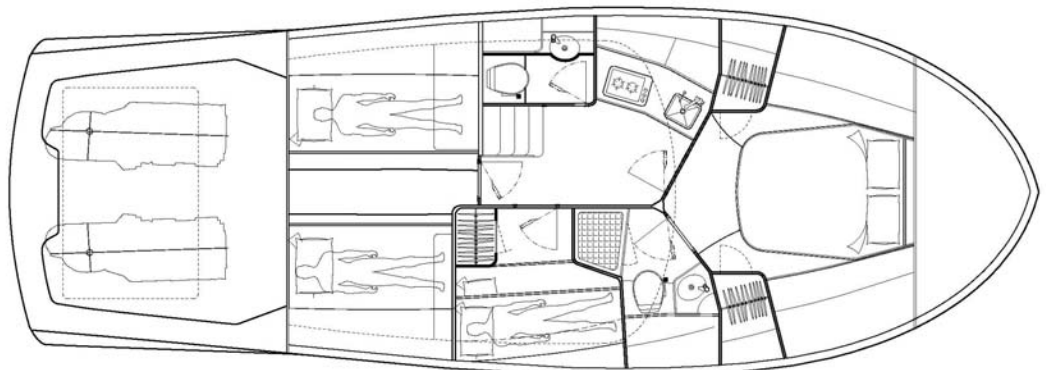

AFT STATEROOM WITH GUEST CABIN/2 HEADS

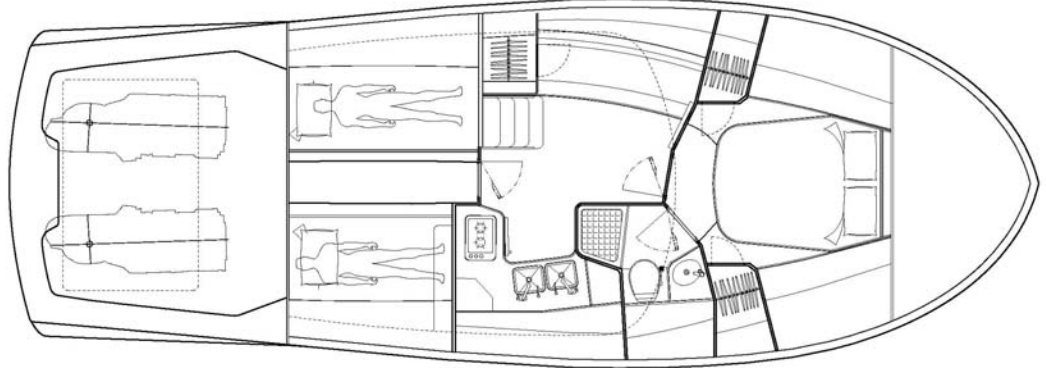

AFT STATEROOM WITH SETTEE/ SALON/ GALLEY STB

\* All Specifications Are Subject To Change Without Notice 11-2010

